

The rechargeable batteries are lead-lead dioxide systems. The dilute sulfuric acid electrolyte is absorbed by separators and thus immobilized. Should the battery be accidentally overcharged producing hydrogen and oxygen, special one-way valves allow the gases to escape thus avoiding excessive pressure build-up. Otherwise, the battery is completely sealed and is, therefore, maintenance-free, leak proof and usable in any position.



## Battery Construction

Component	Positive plate	Negative plate	Container	Cover	Safety valve	Terminal	Separator	Electrolyte
Raw material	Lead dioxide	Lead	ABS	ABS	Rubber	Copper	Fiberglass	Sulfuric acid

## General Feature

- Absorbent Glass Mat(AGM) technology for efficient gas recombination of up to 99% and freedom from electrolyte maintenance or water adding.
- Not restricted for air transport-complies with IATA/ICAO Special Provision A67.
- UL-recognized component.
- Can be mounted in any orientation.
- Computer designed lead, calcium tin alloy grid for high power density.
- Long service life, float or cyclic applications.
- Maintenance-free operation.
- Low self discharge.

## SPECIFICATION

Nominal voltage ..... 12V  
 Number of cell ..... 6  
 Length(mm/inch) ..... 522/20.55  
 Width(mm/inch) ..... 238/9.37  
 Height(mm/inch) ..... 218/8.58  
 Total Height(mm/inch) ..... 223/8.78  
 Approx. Weight(kg/lbs) ..... 58.5/128.9

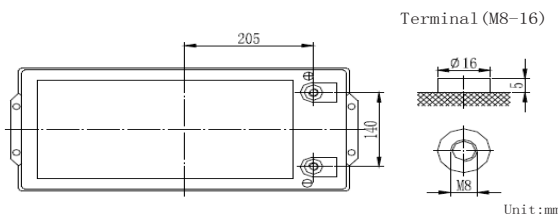
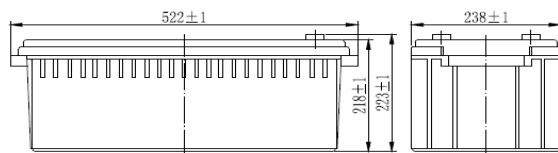

## Performance Characteristics

Capacity 77°F(25°C)	20 hour rate (10A、 10.5V)	200Ah
	10 hour rate (19A、 10.5V)	190Ah
	5 hour rate (34A、 10.5V)	170Ah
	1 hour rate (120A、 9.6V)	120Ah
Internal Resistance	Full charged Battery77°F(25°C): 4mΩ	
Capacity affected by Temperature (20 hour rate)	104° F(40°C)	102%
	77° F(25°C)	100%
	32° F(10°C)	85%
	5° F(-15°C)	65%
Self-Discharge 68°F(20°C)	Capacity after 3 month storage	90%
	Capacity after 6 month storage	80%
	Capacity after 12month storage	60%
Max. discharge current77°F(25°C): 1000A(5S)		
Charge (Constant Voltage)	Float: 13.6~13.8 V/77° F/(25°C)	
	Cycle:14.5~14.9 V/77°F/(25°C) Max.Current: 50A	

### Discharge Constant Current (Amperes at 77°F(25°C))

End Point Volts/Cell	5min	10min	15min	30min	1h	3h	5h	10h	20h
1.60V		405	329	200	120	51.6	35.8	19.7	10.3
1.65V		381	310	192	118	50.8	35.2	19.5	10.2
1.70V		359	291	185	116	50.0	34.6	19.3	10.1
1.75V		335	271	178	114	49.0	34.0	19.0	10.0
1.80V		307	252	171	112	48.0	33.3	18.5	9.95

### Discharge Constant Power (watts at77°F(25°C))

End Point Volts/Cell	5min	10min	15min	30min	45min	1h	2h	3h	5h
1.60V		700	566	374	268	248	137	97.4	70.3
1.65V		666	547	360	262	243	134	96.1	69.7
1.70V		631	530	347	257	238	131	94.8	69.1
1.75V		594	512	332	252	233	128	93.4	68.6
1.80V		564	482	319	247	228	124	92.4	68.1

(Note)The above characteristics data are average values obtained Within three charge/discharge cycles not the minimum values.

